

GROUND FLOOR PLAN
FURNITURE LAYOUT (HOTEL)

Information contained on this drawing is the property of kanon architects. copying or using this drawing in notice or part without written permission is unauthorised.

PROJECT :
PROPOSED G+9 HOTEL &
2 STORAGE RESORT,INNANI
BEACH, COX'S BAZAR .

CLIENT :
BEACH PARADISE HOTEL AND
RESORT PLC

DRAWING TITLE :
GROUND FLOOR PLAN

DRAWING BY :
Saif Uddin Hiron
Architect (DUET)
Kaniz Sufia Shimul
Jr.Architect



CONSULTANT:
KANON ARCHITECTS.
ADDRESS : 1ST FLOOR,HOUSE NO-03,
BLOCK-L,ROAD-2/2,BANANI
DHAKA -1213, BANGLADESH.
CELL : +8801811791189.
Email : kanonarchitects01@gmail.com
Web : www.kanonarchbd.com

ENGINEER :

DRAWING NO :
G+9 HOTEL & 2 STORAGE RESORT.

SHEET NO :

SCALE : NTS

DATE : DECEMBER ,2024

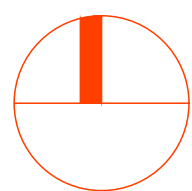

1ST FLOOR PLAN
FURNITURE LAYOUT (HOTEL)

Information contained on this drawing is the property of kanon architects. copying or using this drawing in notice or part without written permission is unauthorised.

PROJECT :
PROPOSED G+9 HOTEL &
2 STORAGE RESORT,INNANI
BEACH, COX'S BAZAR .

CLIENT :
BEACH PARADISE HOTEL AND
RESORT PLC

DRAWING TITLE :
1ST FLOOR PLAN

DRAWING BY :
Saif Uddin Hiron
Architect (DUET)
Kaniz Sufia Shimul
Jr.Architect

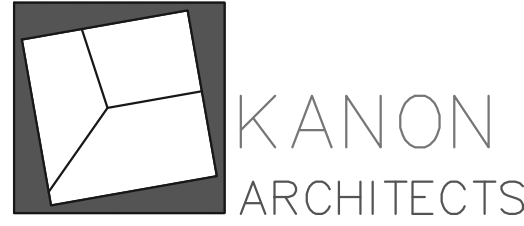

CONSULTANT:
KANON ARCHITECTS.
ADDRESS : 1ST FLOOR,HOUSE NO-03,
BLOCK-L,ROAD-2/2,BANANI
DHAKA -1213, BANGLADESH.
CELL : +8801811791189.
Email : kanonarchitects01@gmail.com
Web : www.kanonarchbd.com

ENGINEER :

DRAWING NO :
G+9 HOTEL & 2 STORAGE RESORT.

SHEET NO :

SCALE : NTS

DATE : DECEMBER ,2024



2ND FLOOR PLAN
FURNITURE LAYOUT (HOTEL)

Information contained on this drawing is the property of kanon architects. copying or using this drawing in notice or part without written permission is unauthorised.

PROJECT :
PROPOSED G+9 HOTEL &
2 STORAGE RESORT,INNANI
BEACH, COX'S BAZAR .

CLIENT :
BEACH PARADISE HOTEL AND
RESORT PLC

DRAWING TITLE :
2ND FLOOR PLAN

DRAWING BY :
Saif Uddin Hiron
Architect (DUET)
Kaniz Sufia Shimul
Jr.Architect

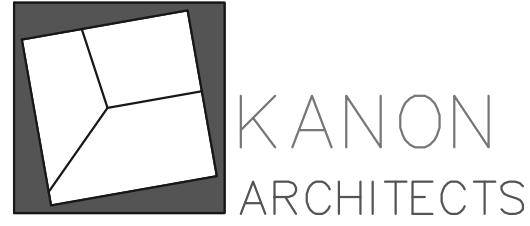

CONSULTANT:
KANON ARCHITECTS.
ADDRESS : 1ST FLOOR,HOUSE NO-03,
BLOCK-L,ROAD-2/2,BANANI
DHAKA -1213, BANGLADESH.
CELL : +8801811791189.
Email : kanonarchitects01@gmail.com
Web : www.kanonarchbd.com

ENGINEER :

DRAWING NO :
G+9 HOTEL & 2 STORAGE RESORT.

SHEET NO :

SCALE : NTS

DATE : DECEMBER ,2024

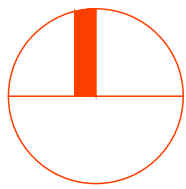

TYPICAL FLOOR PLAN
FURNITURE LAYOUT (HOTEL)

Information contained on this drawing is the property of kanon architects. copying or using this drawing in notice or part without written permission is unauthorised.

PROJECT :
PROPOSED G+9 HOTEL &
2 STORAGE RESORT,INNANI
BEACH, COX'S BAZAR .

CLIENT :
BEACH PARADISE HOTEL AND
RESORT PLC

DRAWING TITLE :
TYPICAL FLOOR PLAN

DRAWING BY :
Saif Uddin Hiron
Architect (DUET)
Kaniz Sufia Shimul
Jr.Architect



CONSULTANT:
KANON ARCHITECTS.
ADDRESS : 1ST FLOOR,HOUSE NO-03,
BLOCK-L,ROAD-2/2,BANANI
DHAKA -1213, BANGLADESH.
CELL : +8801811791189.
Email : kanonarchitects01@gmail.com
Web : www.kanonarchbd.com

ENGINEER :

DRAWING NO :
G+9 HOTEL & 2 STORAGE RESORT.

SHEET NO :

SCALE : NTS

DATE : DECEMBER ,2024



 **ROOF TOP PLAN**
FURNITURE LAYOUT (HOTEL)

Information contained on this drawing is the property of kanon architects. copying or using this drawing in notice or part without written permission is unauthorised.

PROJECT :
PROPOSED G+9 HOTEL &
2 STORAGE RESORT,INNANI
BEACH, COX'S BAZAR .

CLIENT :
BEACH PARADISE HOTEL AND
RESORT PLC

DRAWING TITLE :
ROOF TOP PLAN

DRAWING BY :
Saif Uddin Hiron
Architect (DUET)
Kaniz Sufia Shimul
Jr.Architect

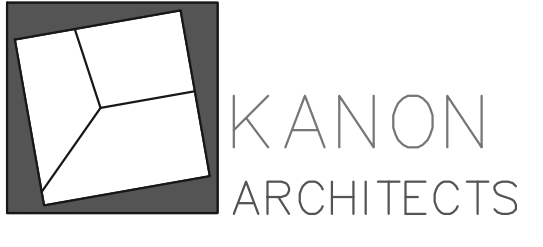

CONSULTANT:
KANON ARCHITECTS.
ADDRESS : 1ST FLOOR,HOUSE NO-03,
BLOCK-L,ROAD-2/2,BANANI
DHAKA -1213, BANGLADESH.
CELL : +8801811791189.
Email : kanonarchitects01@gmail.com
Web : www.kanonarchbd.com

ENGINEER :

DRAWING NO :
G+9 HOTEL & 2 STORAGE RESORT.

SHEET NO :

SCALE : NTS

DATE : DECEMBER ,2024